

TECHNICAL DATASHEET

TOPLA ENERGY E75X

ORDER INFORMATION

TAB ID

1000218

Short Code

E75X

DIN Marking

57413 SMF

EAN Code

3838807036772

Quantity per EU/CNT pallet

51/80 pcs

TECHNOLOGY

Primary Function

Engine Start

Battery Technology

Flooded

Grid Type (pos/neg)

Expanded/Concasted

Grid Alloy (pos/neg)

Ca/Ca

Separator

PE

Electrolyte (g/cm³)

1,28

TECHNICAL INFORMATION

Voltage (V)

12

Capacity C20 (Ah)

75

CCA -18°C EN (A)

700

RC (min)

130

LxWxH (mm)

278x175x190

Total Weight (kg)

17.2

BOX DESIGN

Box Type

L3

Cover Type

SMF

Colour

Black

Layout

1

BHD

B13

Terminal

1

DRAWING

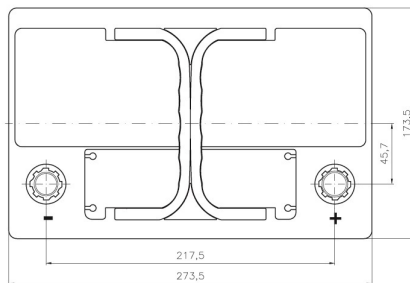
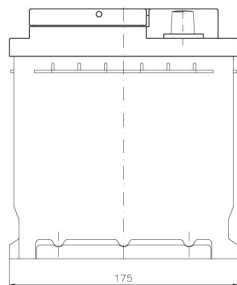
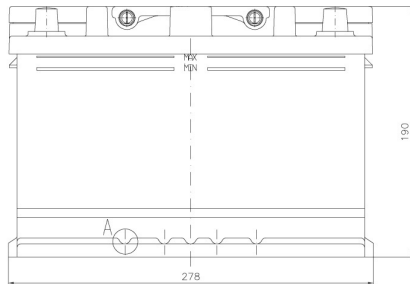

BHD



LAYOUT

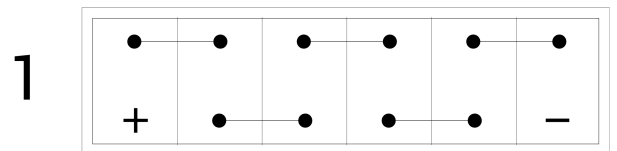

TERMINAL



TECHNICAL DATASHEET

TOPLA ENERGY E75X