



TECHNICAL DATASHEET

TOPLA TOP TT78H

ORDER INFORMATION

TAB ID

1000317

Short Code

TT78H

DIN Marking

57549 SMF

EAN Code

3838807027589

Quantity per EU/CNT pallet

51/80 pcs

TECHNOLOGY

Primary Function

Engine Start

Battery Technology

Flooded

Grid Type (pos/neg)

Expanded/Concasted

Grid Alloy (pos/neg)

Ca/Ca

Separator

PE

Electrolyte (g/cm3)

1,28

TECHNICAL INFORMATION

Voltage (V)

12

Capacity C20 (Ah)

78

CCA -18°C EN (A)

750

RC (min)

135

LxWxH (mm)

278x175x190

Total Weight (kg)

17.5

BOX DESIGN

Box Type

L3

Cover Type

SMF

Colour

Black

Layout

0

BHD

B13

Terminal

1

DRAWING

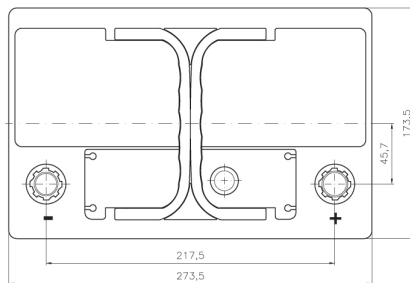
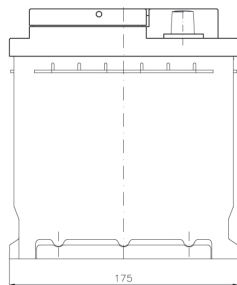
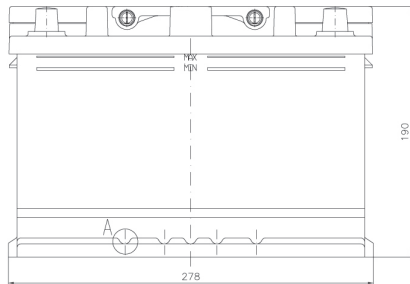

BHD



LAYOUT

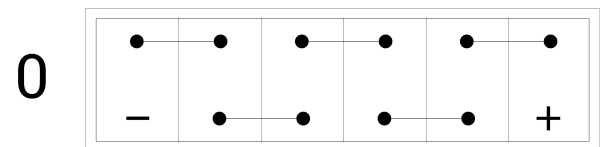

TERMINAL



TECHNICAL DATASHEET

TOPLA TOP TT78H