



TECHNICAL DATASHEET

TAB POLAR S73

ORDER INFORMATION

TAB ID

1000872

Short Code

S73

DIN Marking

57309 SMF

EAN Code

3838807027022

Quantity per EU/CNT pallet

51/80 pcs

TECHNOLOGY

Primary Function

Engine Start

Battery Technology

Flooded

Grid Type (pos/neg)

Expanded/Concasted

Grid Alloy (pos/neg)

Ca/Ca

Separator

PE

Electrolyte (g/cm³)

1,28

TECHNICAL INFORMATION

Voltage (V)

12

Capacity C20 (Ah)

73

CCA -18°C EN (A)

630

RC (min)

126

LxWxH (mm)

278x175x175

Total Weight (kg)

15.9

BOX DESIGN

Box Type

L3B

Cover Type

SMF

Colour

Black

Layout

0

BHD

B13

Terminal

1

DRAWING

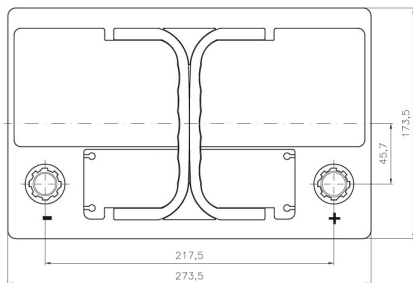
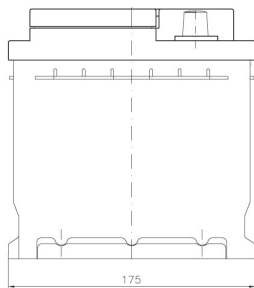
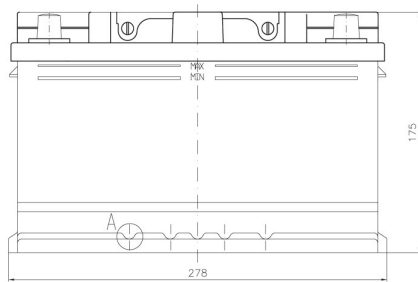

BHD



LAYOUT

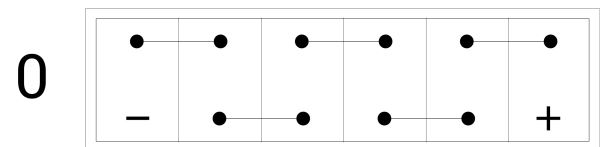

TERMINAL



TECHNICAL DATASHEET

TAB POLAR S73