



## TECHNICAL DATASHEET

# VESNA PREMIUM PR75H

### ORDER INFORMATION

TAB ID

**1001584**

Short Code

**PR75H**

DIN Marking

**57549 SMF**

EAN Code

**3838807033146**

Quantity per EU/CNT pallet

**51/80 pcs**

### TECHNOLOGY

Primary Function

**Engine Start**

Battery Technology

**Flooded**

Grid Type (pos/neg)

**Expanded/Concasted**

Grid Alloy (pos/neg)

**Ca/Ca**

Separator

**PE**

Electrolyte (g/cm3)

**1,28**

### TECHNICAL INFORMATION

Voltage (V)

**12**

Capacity C20 (Ah)

**78**

CCA -18°C EN (A)

**750**

RC (min)

**136**

LxWxH (mm)

**278x175x190**

Total Weight (kg)

**17.5**

### BOX DESIGN

Box Type

**L3**

Cover Type

**SMF**

Colour

**Black**

Layout

**0**

BHD

**B13**

Terminal

**1**

## DRAWING

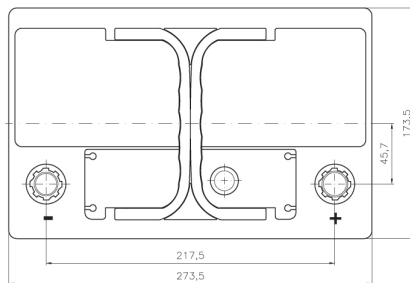
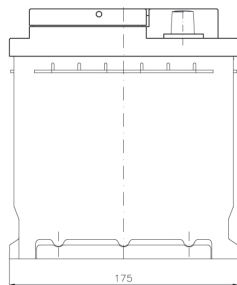
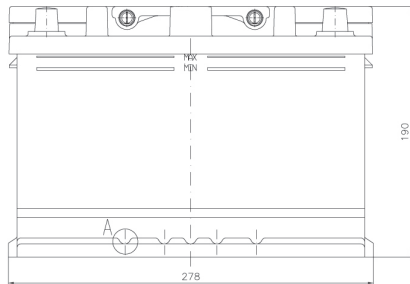

## BHD



## LAYOUT



## TERMINAL



## TECHNICAL DATASHEET

### VESNA PREMIUM PR75H