

TECHNICAL DATASHEET

VESNA HR – HOT REGION MF57412

ORDER INFORMATION

TAB ID
615074

Short Code
MF57412

DIN Marking

EAN Code
3838807040960

Quantity per EU/CNT pallet
0/108 pcs

TECHNOLOGY

Primary Function
Engine Start

Battery Technology
Flooded

Grid Type (pos/neg)
Expanded/Concasted

Grid Alloy (pos/neg)
Ca/Ca

Separator
PE

Electrolyte (g/cm³)
1,28

TECHNICAL INFORMATION

Voltage (V)
12

Capacity C20 (Ah)
74

CCA -18°C EN (A)
620

RC (min)
128

LxWxH (mm)
278x175x190

Total Weight (kg)
16.6

BOX DESIGN

Box Type
L3

Cover Type
SMF

Colour
Black

Layout
0

BHD
B13

Terminal
1

DRAWING

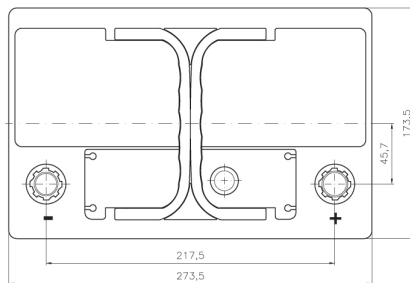
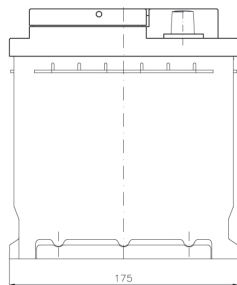
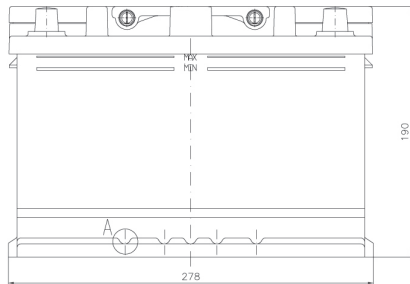

BHD



LAYOUT

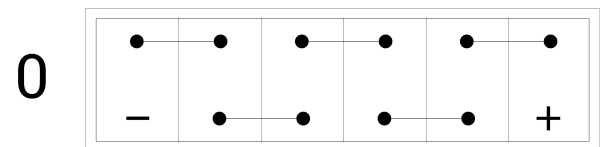

TERMINAL



TECHNICAL DATASHEET

VESNA HR – HOT REGION MF57412

TAB d.d, Polena 6, SI-2392 Mežica, Slovenia, www.tab.si