



TECHNICAL DATASHEET

TAB POLAR S74HX

ORDER INFORMATION

TAB ID
246374

Short Code
S74HX

DIN Marking
57413 SMF

EAN Code
3838807036659

Quantity per EU/CNT pallet
51/80 pcs

TECHNOLOGY

Primary Function
Engine Start

Battery Technology
Flooded

Grid Type (pos/neg)
Expanded/Concasted

Grid Alloy (pos/neg)
Ca/Ca

Separator
PE

Electrolyte (g/cm³)
1,28

TECHNICAL INFORMATION

Voltage (V)
12

Capacity C20 (Ah)
74

CCA -18°C EN (A)
680

RC (min)
128

LxWxH (mm)
278x175x190

Total Weight (kg)
17.2

BOX DESIGN

Box Type
L3

Cover Type
SMF

Colour
Black

Layout
1

BHD
B13

Terminal
1

DRAWING

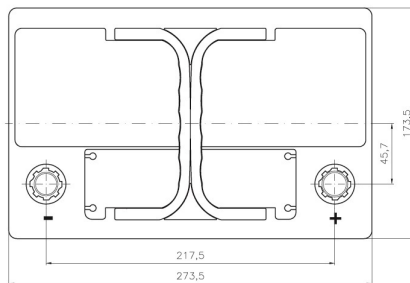
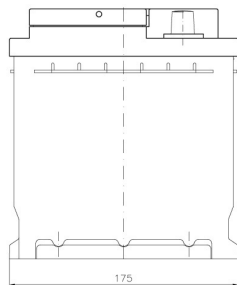
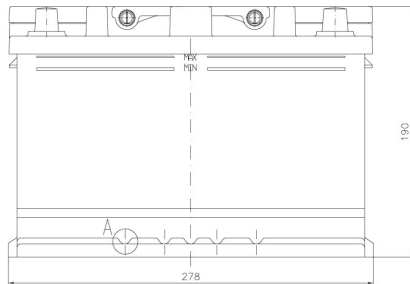

BHD

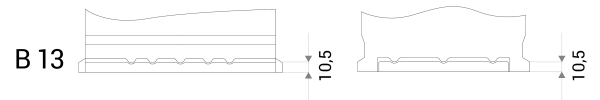

LAYOUT

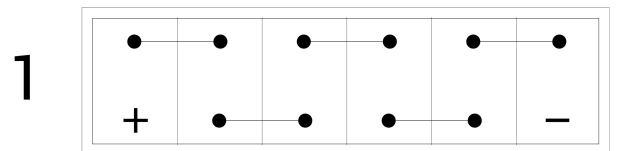

TERMINAL



TECHNICAL DATASHEET

TAB POLAR S74HX